

ITEM	PART NUMBER	DESCRIPTION
1	070006253	TUBE-CROSS LONG-BIN
2	070006254	TUBE-SIDE SHORT-BIN
3	070006255	TUBE-SIDE LONG-BIN
4	070006256	TUBE-OUTSIDE-BIN
5	070006257	TUBE-CENTER-BIN
6	070006258	TUBE-CROSS SHORT BIN
7	070006259	BRKT-ARM-SHUTLE ASSEMBLY
8	070006260	BUMPER-COUNTER-BIN
9	070006261	CLAMP-END-BIN
10	070006265	PIN HOLDER

ITEM	PART NUMBER	DESCRIPTION
11	070006266	STRAP-SPRING-BIN
12	070006268	STRAP-BIN-SHUTLE ASSEMBLY
12A*		STRAP-BIN-SHUTLE ASSEMBLY (NO LONGER AVAILABLE)
13	808549240	SCREW-SOBT1/4-20 X 1 1/2
13A	809849325	1/4-20 X 2 CAP SCREW
14	809849245	SCREW-HEX 1/4-20 X 1 1/2
15	809849285	SCREW-HEX 1/4-20 X 1 3/4
16	844049002	1/4-20 LOCK NUT
19	070006390	SPACER
20	070006447	SPRING-SHUTLE ASSEMBLY

070006265 PIN HOLDER

Features:

- Made of original material
- Will not hold the pin like urethane
- Exceptional long wear



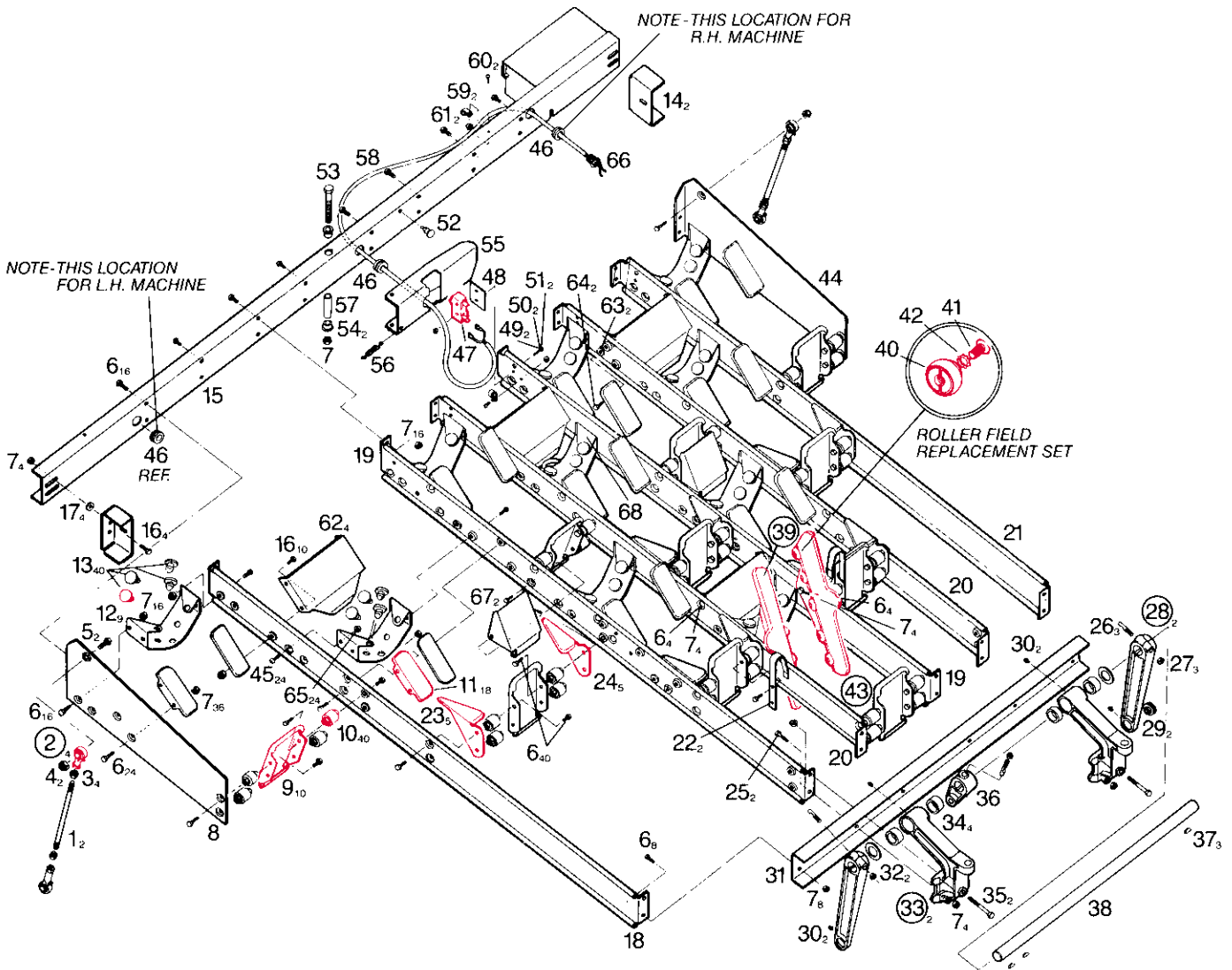

ITEM	PART NUMBER	DESCRIPTION
1	070006351	ROD-BIN ASSEMBLY
2	000026446	ROD END
2A	090005250	ROD END
3	835566002	3/8-24 HEX STL THIN NUT
4	844065002	NUT-STVR 3/8-16
5	809865165	SCREW-HEX 3/8-16 X 1
6	809849085	SCREW-HEX 1/4-20 X 1/2
7	844049002	1/4-20 LOCK NUT
8	070006370	GUIDE-PIN-LH-BIN ASSEMBLY
9	070006364	SPACER-BUT GUIDE-BIN
10	070006354	SHOCK MOUNT-BIN ASSEMBLY
11	070006353	GUIDE-PIN-BIN ASSEMBLY
12	070006359	BRKT-BIN ASSEMBLY
13	000021992	BUMPER-GROMMET #2250
14	070006371	BRKT-SUPT-BIN ASSEMBLY
15	070006360	CHANNEL LONG WELDMENT
16	809849125	SCREW-HEX 1/4-20 X 3/4
17	948753102	WASHER-9/32 X 5/8 X 1/16
18	070006377	STRINGER 4 PIN L.H.
19	070006372	STRINGER CTR RH
20	070006373	STRINGER #1 PIN LH
21	070006376	STRINGER-OUTSIDE RH
22	070006389	GUIDE-PIN 1
23	070006381	GUIDE-PIN 6-BIN ASSEMBLY
24	070006380	GUIDE-PIN 4-BIN ASSEMBLY
25	809849285	SCREW-HEX 1/4-20 X 1 3/4
26	070006403	STUD-CLAMP-BIN ASSEMBLY
27	831565002	3/8-16 HEX STEEL MACHINE NUT
28	070006429	ARM CSTG ASSEMBLY LH & RH
29	000029614	HEIM UNIBAL
30	710501007	FITTING-ALMTE 1792B
31	070006363	CHANNEL-SHORT
32	701329050	BEARING TH .8905 X 1.5 X 1/8
33	070006358	BRKT ASSEMBLY-BIN ASSEMBLY
34	900114101	BEARING SL .877 X 1.128 X 5/8

ITEM	PART NUMBER	DESCRIPTION
35	809849485	SCREW-HEX 1/4-20 X 3
36	070006408	LEVER-BIN ASSEMBLY
37	907000600	KEY-HY PRO 706
38	070006402	SHAFT-BIN ASSEMBLY
39	070006386	TRACK ASSY L H
40	000026251	BEARING RESPOT CELL
41	813540082	SCREW-TRHD 10-32 X 1/2 CD
42	957100002	#10 EXT TOOTH LOCKWASHER. PLTD
43	070006388	TRACK ASSY R H
44	070006369	GUIDE-PIN RH-BIN ASSEMBLY
45	808549080	1/4-20 X 1/2 HEX SCKT BUTHD CAP
46	711516020	GRMT-ATL 1/2ID *2861
47	000026043	SWITCH-MICRO
48	000021575	INSULATOR
49	818227162	SCREW-SMRD 6-32 X 1
50	843127002	NUT-KEP 6-32 WASH
51	948631062	WASHER #6 SAE FLAT WASHER
52	070006142	BUMPER
53	809849605	SCREW-HEX 1/4-20 X 3 3/4
54	900206091	BEARING FL. (.562 X .688 X .378)
55	070006356	SWITCH ACTUATOR-BIN
56	000022168	SPRING SWEEP BRAKE
57	070006108	SPACER-ROLER AY-DIST
58	070006272	SWITCH CABLE ASSM
59	744203014	CLAMP-BURNDY HP-6N
60	818233082	SCREW-SMRD 8-32 X 1/2
61	843133002	NUT-KEP 8-32 WASH
62	070006366	SPACER-GUIDE PIN HED
63	070006390	SPACER
64	809849165	SCREW-HEX 1/4-20 X 1
65	840049002	NUT FLEX 1/4-20
66	746001016	CNECTR-STR #3302 1/2
67	070006365	SPACER-HEAD GUID.BIN
68	070006384	BRKT-PIN 5

070006354 BIN SHOCK MOUNT

Features:

- Encapslated inserts
- Soft rubber
- Max deflection-good absorption
- Extends life of runners and pin butts
- Nut is inside which prevents it from breaking off

610700150 SWEEP BAR FOR 2 MACHINES

Features:

- Single piece construction, virtually unbreakable
- Lighter than old multi-piece type sweep

NOTE : SWEEP BAR, SWEEP BRACKET AND SWEEP SHOCK MOUNT LOCATED ON PAGE 26

000023170 & 000023171 SWEEP BRACKET RH & LH

Features:

- 10 gauge steel/metal
- Redesigned cross section to 1.4" wide
- Optimizes weight to strength
- Minimizes stress on bushings, shock mounts and motor load

070003195 & 090006136 SWEEP SHOCK MOUNT

Features:

- 3-holes drilled in plates on both sides which makes it resistant to tearing
- Flexible enough to prevent damage to the sweep links
- Rubber is inside the plate



82-70 PINSPOTTER

PARTS CATALOG

